

## COMPACT TRAPPING STATION UniAdca CTS 40 ( DN 1/2" - 1" DN 15 - 25 )

**DESCRIPTION**

The UniAdca CTS is designed as a complete and compact steam trap station used in steam systems where a simplified and economical maintenance program of steam is desired. It has been designed to replace a traditional multi-component trap station system.

Typical installations are drip service on steam lines, tracing and small process equipment.

Two bolt flange connector permits trap replacement in minutes without disturbing piping.

The CTS trapping station fits all UniAdca steam traps.

Connections are female screwed or flanged.

**MAIN FEATURES**

Remains in-line permanently making replacing of new traps easier and quicker.

UniAdca steam traps can swivel 360° allowing any pipe orientation during installation.

The universal flange allows the trap to be positioned in the correct position, regardless of pipeline configuration.

Built-in strainer.

USE: Saturated and superheated steam.

AVAILABLE

MODELS: CTS40S - Forged steel construction  
CTS40SS - Stainless steel construction

SIZES: DN 1/2", 3/4" and 1"  
DN 15, 20 and 25.

CONNECTIONS: Female screwed ISO 7/1 Rp (BS21).  
Flanged EN 1092-1 or ANSI.

INSTALLATION: Can be installed in any position according to the type of UniAdca steam trap to be used.

See IMI installation and maintenance instructions.

PMA – Max. allowable pressure 80 bar

TMA – Max. allowable temperature 425 °C

PMO – Max. operating pressure 32 bar

TMO –Max. operating temperature 400 °C

How to order: i.e. CTS40S DN1/2" BSP

**Legend :**

- 2 - Upstream isolation valve
- 3 - Downstream isolation valve
- 4 - Upstream line drain and bypass valve
- 5 - Downstream depressurisation and trap testing valve

**DIMENSIONS (mm)-Screwed**

SIZE DN	A	B	C	D	E	F	G	WGT. Kgs
1/2"	110	250	220	95	125	75	50	3,9
3/4"	110	250	220	95	125	75	50	3,9
1"	110	250	220	95	125	79	54	4,5

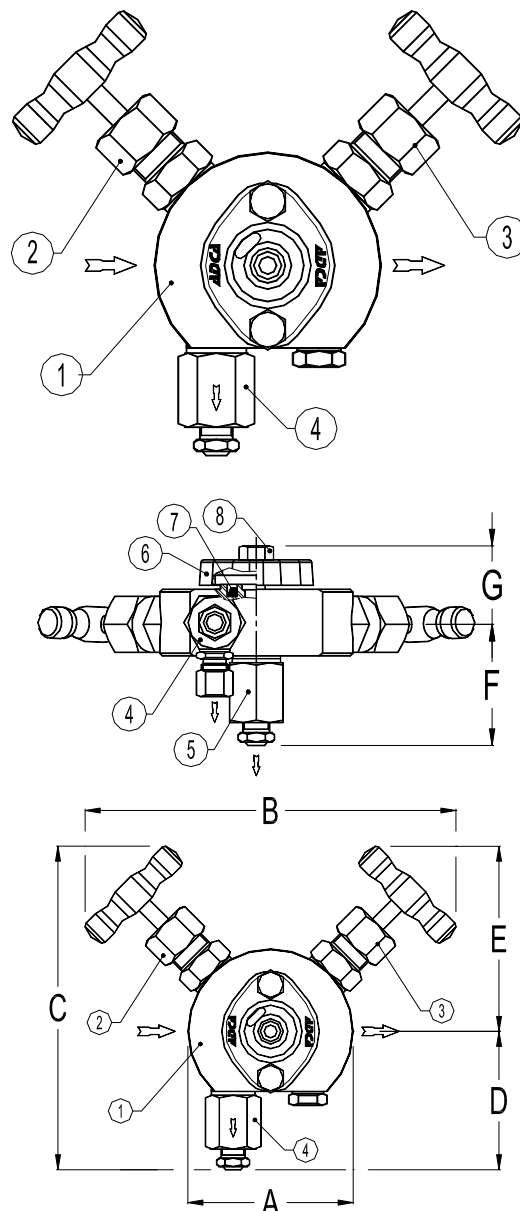
**MATERIALS**

POS. N r.	DESIGNATION	MATERIAL CTS40S	MATERIAL CTS40SS
1	Body	P250GH / 1.0460	AISI316 / 1.4401
2	* Upstr.valve	AISI304 / 1.4301	AISI304 / 1.4301
3	* Downst.valve	AISI304 / 1.4301	AISI304 / 1.4301
4	* By-pass valve	AISI304 / 1.4301	AISI304 / 1.4301
5	* Dep.valve	AISI304 / 1.4301	AISI316 / 1.4401
6	Flange	P250GH / 1.0460	AISI316 / 1.4401
7	Strainer	AISI304 / 1.4301	AISI304 / 1.4301
8	Bolts	A4-80	A4-80

\* Available spare parts