

## THERMOSTATIC STEAM TRAPS AND AIR ELIMINATORS TSW 22 (Stainless Steel Wafer Design)

### DESCRIPTION

The TSW all stainless steel thermostatic steam traps and air eliminators are specifically designed for use on process equipment such as kettle cookers, sterilizers, food, chemical and laundry equipment. The small size make it ideal for use with a wide variety of this equipment.

Connections are flanged ( sandwich ).

### MAIN FEATURES

Modulating discharge.

Discharges condensate close to steam temperature.

Thermostats for different sub cooling (5°K to 30°K).

Excellent air discharge.

Operates on moderate superheated steam.

Simple and compact design

Can operate in any plane

USE: Saturated steam

AVAILABLE

MODELS: TSW 22

SIZES: DN15 to DN 25

CONNECTIONS: Sandwiched between flanges as per EN 1092-1 PN16/PN40

INSTALLATION: Any position  
See IMI installation and maintenance instructions.

PMA	Max. allowable pressure	32 bar
TMA	Max. allowable temperature	300 °C
PMO	Max. operating pressure	22 bar
TMO	Max. operating temperature	250 °C

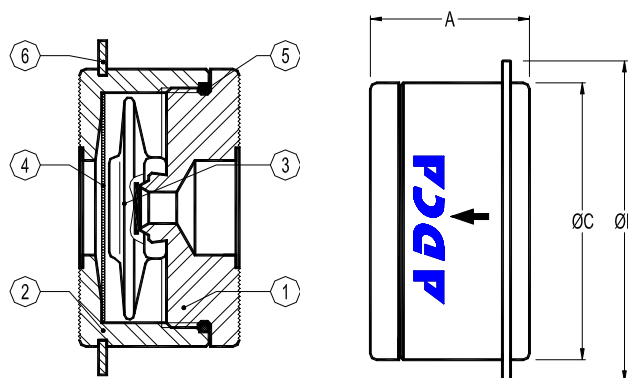
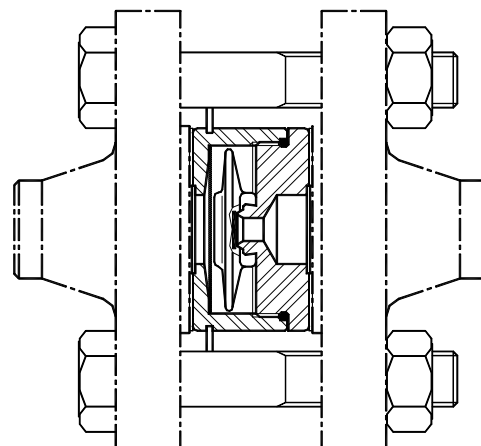

DIMENSIONS (mm)				
SIZE DN	A	B	C	WEIGHT Kgs
15	25	51	43	0,25
20*	31,5	61	53	0,45
25	35,5	71	64	0,75

\*DN 20 is suitable for installation between flanges DN15

removing the centering ring.

DN 15 and DN 25 available only on request.

MATERIALS		
POS.Nr.	DESIGNATION	MATERIAL
1	Body	AISI304 / 1.4301
2	Cover	AISI304 / 1.4301
3	* Thermostatic element	Stainless steel
4	* Strainer screen	AISI304 / 1.4301
5	* Gasket	St. Steel / Graphite
6	Centering ring	AISI304 / 1.4301

\* Available spare parts

FLOW RATE CAPACITY IN Kgs/h																
MODEL	SIZE	DIFFERENTIAL PRESSURE (bar)														
		0,2	0,3	0,5	1	1,5	2	3	4	6	8	10	13	15	20	22
TSW 22	15 - 25	70	120	140	255	330	385	455	510	600	670	700	720	750	775	795

Capacities shown refer to condensate at 10°C below saturated steam temperature (standard type-S thermostat) .

Thermostats for 5° C type-H and 30° type-L, also available.

Capacities for cold condensate discharge at 20°C are two to three times greater.